

**Date Issued: 8 April 2024**

**NOTICE OF AN APPLICATION FOR A PLANNING PERMIT**

The land affected by the application is located at: **12 Queen Street, Avenel VIC 3664**  
The application is for a Permit for: **Two (2) lot subdivision**  
The applicant for the Permit is: **Planography Pty Ltd**  
The application Reference Number is: **P2024-010**

You may view the application and any documents that support the application on our website at:

<https://www.strathbogie.vic.gov.au/services/building-and-planning/planning-applications-currently-advertised/>

or at the office of the Responsible Authority during office hours:

*Strathbogie Shire Council* 109A Binney Street Euroa  
*Telephone: (03) 5795 0000*

Any person who may be affected by the granting of the Permit may object or make other submissions to the Responsible Authority.

An objection must be sent to the Responsible Authority in writing, include the reasons for the objection and state how the objector would be affected.

*The Responsible Authority will not decide on the application before: **29 April 2024***

All objections are placed on the relevant Planning Permit application file, which is publicly available at all times. Objections can therefore be read and used by other parties.

An objection form is available from Strathbogie Shire Council office, by phoning Council on (03) 5795 0000 or at:

<https://www.strathbogie.vic.gov.au/development/statutory-planning/objections>

If you submit an objection, the Responsible Authority will tell you of its final decision.

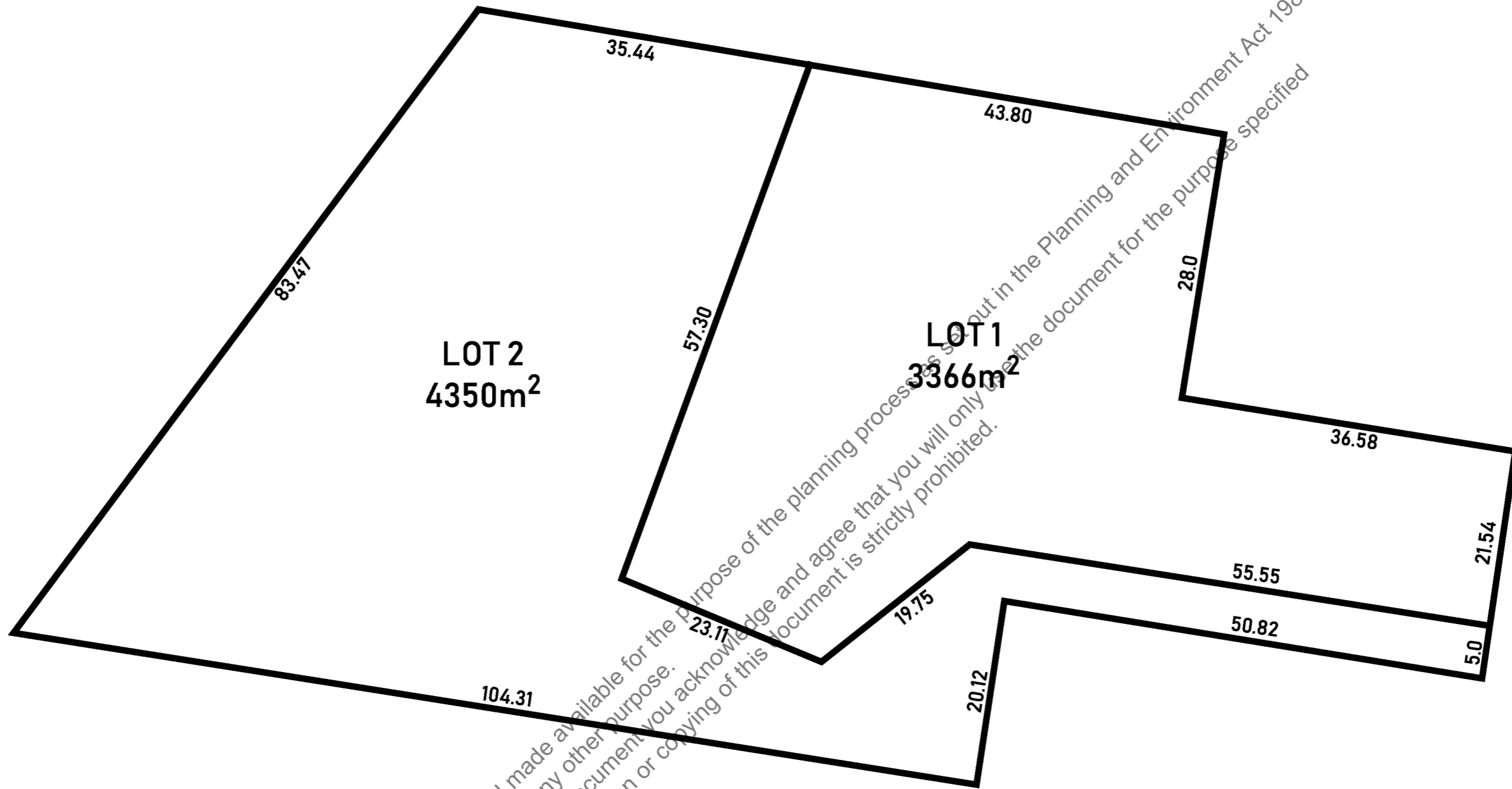

**QUEEN STREET**

This document has been copied and made available for the purpose of the planning process set out in the Planning and Environment Act 1987. The information must not be used for any other purpose. By taking a copy of or downloading the document you acknowledge and agree that you will only use the document for the purpose specified above and that any dissemination, distribution or copying of this document is strictly prohibited.

Site:	<b>12 QUEEN STREET, EUROA</b>	Drawing: <b>24005-2</b>	Project: <b>24005</b>	Drawn: <b>TS</b>		<b>PLANOGRAPHY PTY LTD</b>
Title:	<b>SUBDIVISION LAYOUT PLAN (No Aerial)</b>	Scale: <b>1:300</b>	Date: <b>19/03/2024</b>	Rev: <b>B</b>		