

GV HIGHWAY DIAMOND INTERCHANGE  
ROUND-A-BOUT AT MITCHELLSTOWN ROAD

Strathbogie Shire Council



Statement of Landscape Intent

The landscape design seeks to connect the local community and visitors with the natural bushland environment as well as surrounding wineries, waterways, wetlands and wildlife.

The GV Highway Diamond Interchange round-a-bout at Mitchelstown Road acts as a fundamental arrival / welcome space for people going to Nagambie.

The design is to contribute positively to the image, identity, functionality, and overall quality of Nagambie.

The design seeks to:

- Reward travelers who exit the Goulburn Valley Highway with a sense of arrival to Nagambie.
- Frame views to Nagambie with low curved gabion rock walls and other materials (a continuation of material used along the Nagambie waterfront).
- Achieve a contextually appropriate softscape planting palette which features a variety of low native plant species.
- The combination of gravels and rock, has been selected to assist in grounding the design in the surrounding natural environment.







LEGEND

- ① **GABION WALL**  
1m high curved gabion walls to frame views through to Nagambie. Gabion walls to be a continuation of the Nagambie Lake upgrade.
- ② **LOW PLANTING**  
Native tussock grasses and ground covers to help soften surrounding materials. Grass species to be drought resistant and low maintenance, moving with the wind.
- ③ **EXISTING SCULPTURE**  
Corten steel sculpture with wine glass shaped element. New solar powered in-ground uplighting to offer night time illumination.
- ④ **PEBBLE MULCH**  
A combination of two gravel types to extend throughout the area, with weed matting beneath. Gravel colours to pay homage to red sandy soils in the region.



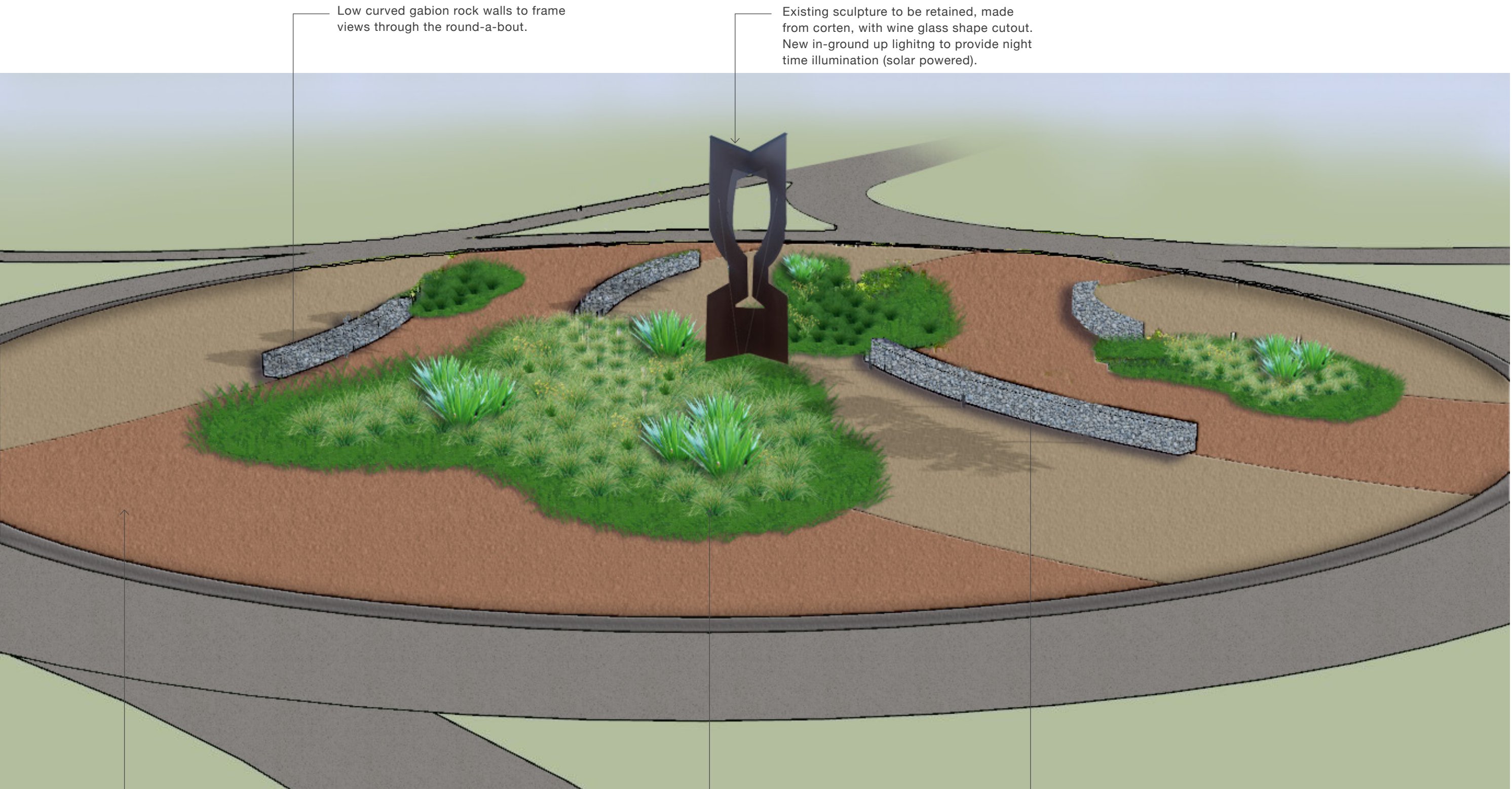

Low curved gabion rock walls to frame views through the round-a-bout.

Existing sculpture to be retained, made from corten, with wine glass shape cutout. New in-ground up lighting to provide night time illumination (solar powered).

A low maintenance surface treatment, using a combination of two pebble types to extend throughout the area, with weed matting beneath. Gravel colours to pay homage to red sandy soils in the region.

Low native grasses planted in large groups, with larger sculptural planting such as Doryanthus sp.

Low curved gabion rock walls to frame views through the round-a-bout.



Code	Botanic Name	Common Name
Shrubs		
1	Westringea fruticosa	Coastal Rosemary
Feature Plants		
2	Doryanthes excelsa	Gynea Lily
3	Furcraea foetida	False Agave
4	Xanthorrhoea sp.	Native Grass Tree
Tussock Grasses		
5	Austrodanthonia sp.	Wallaby Grass
6	Poa crassicaudex	Thick stem tussock grass
7	Poa labillardieri	Common tussock grass
8	Themeda triandra	Kangaroo grass
Ground Covers		
9	Myoporum parvifolium	Creeping Boobilia

Planting Approach: Low native grasses mixed with the sculptural form of Doryanthus/ Furcaea. Native species will be used throughout the area, complimenting the surrounding dry grasslands.

Material Approach: Low curved gabion rock walls to be a continuation of the recent Nagambie Lake Edge upgrade, framing views through to Nagambie. Timber posts to provide a vertical element, referencing the rural setting.

Pebble mulch areas to consist of shades of red and brown, replicating the local soil types. Pebbles to achieve a curved pattern with gabion rock walls, providing a low maintenance surface treatment with visual interest.



Type 1: Existing pebble



Type 2: Secondary pebble (red).

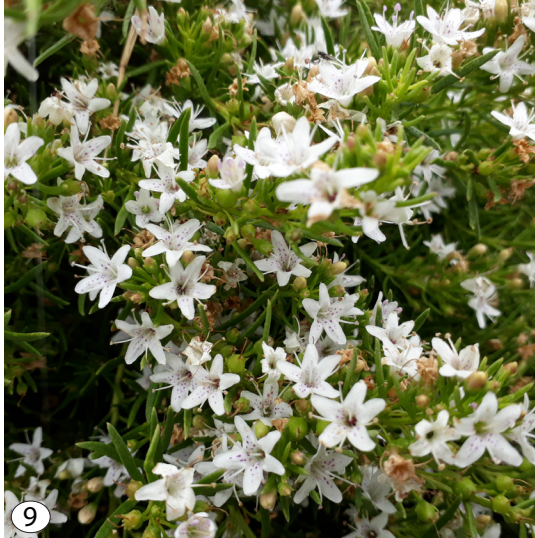



Preliminary Cost Estimate - Nagambie Round-a-bout

PROJECT: Nagambie Streetscape Masterplan  
DATE: 13.08.2021  
Revision: A



Note: This schedule of quantities and items is provided to the client for guidance only.

Item	Description	Unit	Qty	Rate	Amount
1	Round-a-bout				
A	Re-shape existing gravel to suit pattern shown in concept plan.	item	1	\$5,000.00	\$5,000.00
B	Excavate existing ground for new garden beds, nom 300mm depth.	m3	234	\$10.00	\$2,340.00
C	Secondary gravel type imported to suit pattern shown in concept. Red coloured pebble. Nom 20mm. Allowance for weed matting.	m3	155	\$60.00	\$9,300.00
D	1m high curved gabion rock walls.	Lin.m	50	\$350.00	\$17,500.00
E	Garden bed preparation to include 300mm depth imported topsoil.	M3	234	\$50.00	\$11,700.00
F	Supply and install shrub planting: 140mm container	no.	100	\$7.00	\$700.00
G	Supply and install feature planting: 300mm container	no.	300	\$48.00	\$14,400.00
H	Supply and install tussock grasses and ground covers: 140mm container	no.	1,250	\$7.00	\$8,750.00
I	In ground up-lightitng (Solar powered) to be positioned beneath existing sculpture.	no.	3	\$1,500.00	\$4,500.00
TOTAL VALUE (EXC. GST)					\$69,190.00



PREPARED BY PLANIT CONSULTING | [INFO@PLANITCONSULTING.COM.AU](mailto:INFO@PLANITCONSULTING.COM.AU) | [WWW.PLANITCONSULTING.COM.AU](http://WWW.PLANITCONSULTING.COM.AU)

