

VALID
presents the

Shepparton NDIS Expo

Community and Disability supports available to
people with disability, families & supporters

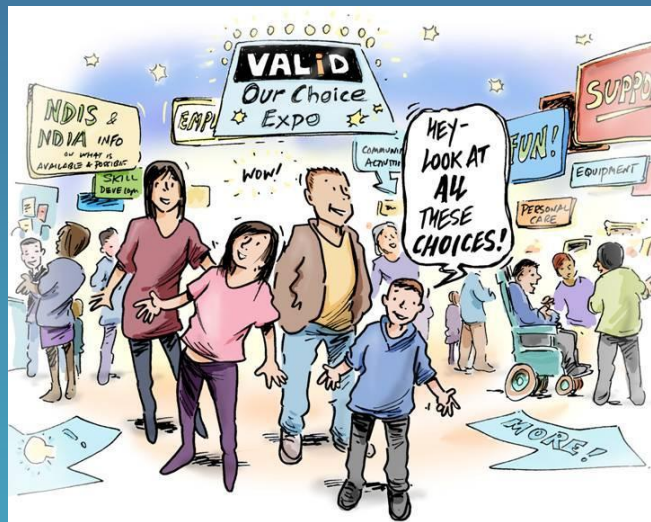

**McIntosh Centre,
Thompson St., Shepparton**

10.00am - 3.00pm

Tuesday 25th September 2018

Search for **VALID Inc.**



Share your comments using **#OurChoiceExpo**



VALID

Supported by



Exhibitors' Listing by Category

Flexible supports	Table No.	NDIA Specific supports	Table No.
Carer Solutions Australia	36	CoAbility	37
Connect GV	18	Family Care - Carer Support/Supt. Coord.	48
Family Care / IntoRec	42	Ideal Plan Manager	30
Goulburn Options	29	Intereach – LAC (Local Area Coord) provider	21
Greycare	26	NDIA - National Disability Insurance Agency	22
GV Health – Disability Services	19	Pathways to Care	24
Sharron Andrea Support Services	14	Uniting (Goulburn North East)	5
Shepparton Access	47		
VMCH – Villa Maria Catholic Homes	7		
Vision Australia	2	Skills, Training & Employment	
Wellways	20	APM Employment Services	25
		OCTEC Ltd	49
Rights & Empowerment		Warner Institute	4
AQA Spire	15		
Clickability	39		
Disability Services Commissioner	23	Equipment & Assistive Technology	
GV Health – Carer Support	40	Australian Hearing	3
Karista	13	Aust. Ramps & Access Solutions	8
RIAC - Rights Information Advocacy Centre	16	Bright Sky	31
VALID: advocacy, training & peer supt	34	Kimberley Clark	12
VEC – Victorian Electoral Commission	32	Medline	46
		Scooters & Mobility Northern Victoria	11
		Word of Mouth Technology	17
Recreation & Travel			
Clubmates Travel	33	Community Info. & Supports	
Leisure Options	35	Arts Access Victoria	45
Ripples & Tonic	6	Community Accessibility	9
Spot On Travel	27	Expression Australia	41
		Greater Shepparton City Council	1
Early Intervention & Therapy		GV Health	19
Scope Victoria	38	Primary Care Connect	28

orgs. list as of 8th of Sept.

Final version available at the Expo

Shepparton Expo - Goulburn Valley area



Thompson Street

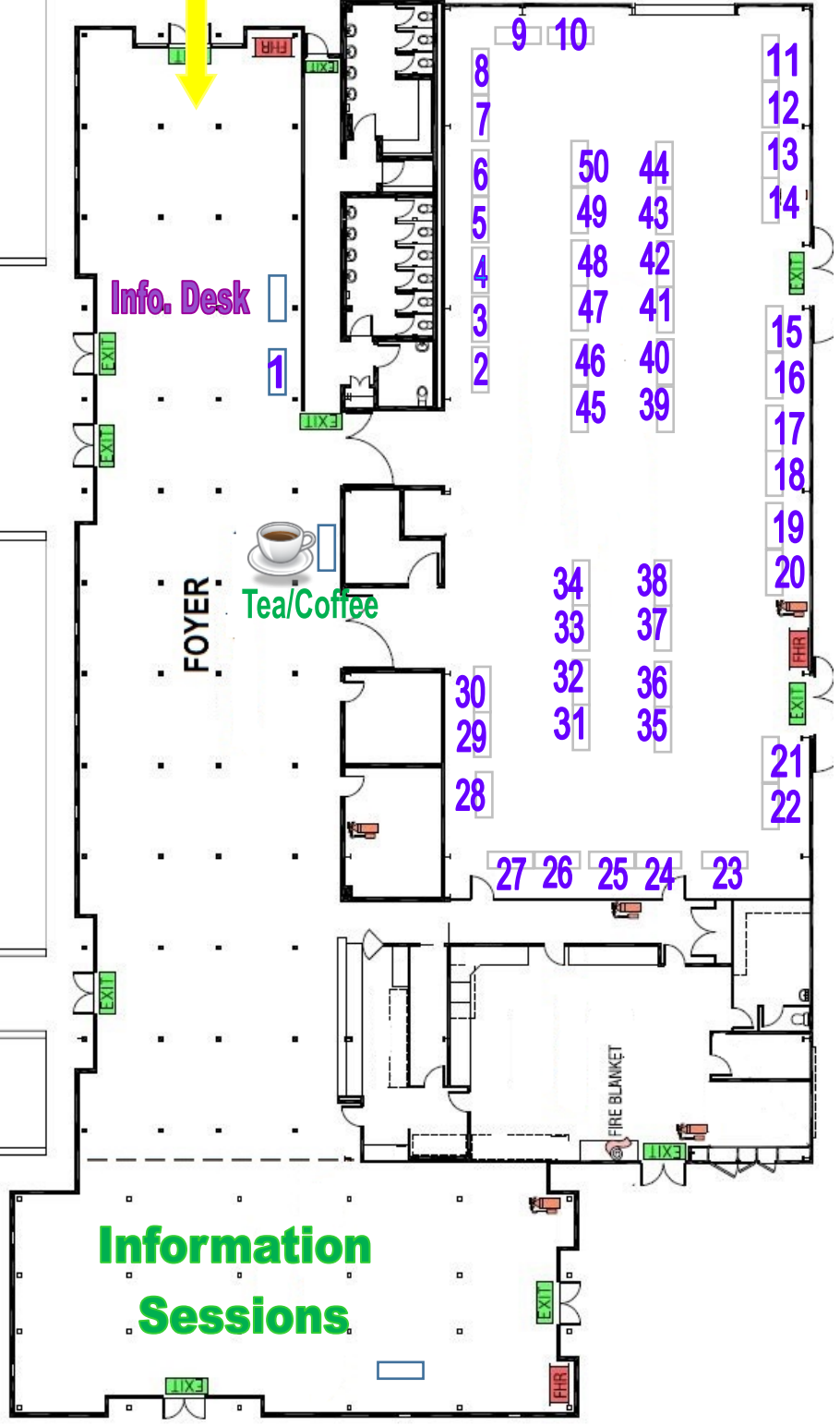

Midland Hwy

INFORMATION SESSION SCHEDULE

Information sessions will be held in the end of the Foyer (see map)

Time	Topic	Presentation Information
10am – 10.45am	NDIS overview then Q&A (Questions & Answers)	NDIA representatives will provide an overview of the basics of the NDIS and then answer questions
11am – 11.45am	Art, the NDIS and You	A workshop by Arts Access. Join us to find out: How art & culture fits in the NDIS. Tips around the NDIS journey. How to advocate for the arts in your NDIS plan. Answers to any questions you might have.
12noon – 12.45pm	Tips for preparing for transition to the NDIS	VALID presentation on practical ways to prepare for the transition to the NDIS, including info on preparing for your first plan.
1pm – 1.45pm	NDIS '101'	Basics of the NDIS (National Disability Insurance Scheme) - who's eligible; how transition is happening; what's funded & what's not - all in user-friendly format presented by VALID
2pm - 2.45pm	Advocacy Support and what to do if things aren't going well with services or the NDIS.	Where do you go if you need support with dealing with services and/or the NDIS? RIAC (Rights Information Advocacy Centre) also supports NDIS participants with formal Appeals about decisions made by the NDIS. & A short talk from the Disability Services Commissioner about their role in complaints about services & other bodies that can assist.

We are here to assist you to participate in the Expo,

so come to the **Info Desk** at Table 1 if you require short term assistance from:



Auslan Interpreter

Attendant Carer



More Info: VALID, 235 Napier St., Fitzroy Vic. 3065
 ph: 03 9416 4003 Freecall: 1800 655 570
 email: bookings@valid.org.au web: www.valid.org.au